

Staples

Upholstery, Plastic, Molding, and Wood-to-Wood

GRABBER®
CONSTRUCTION PRODUCTS

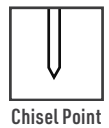
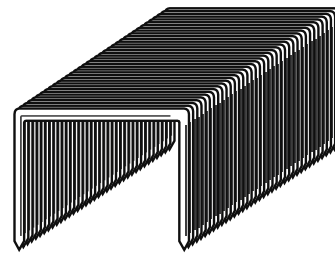
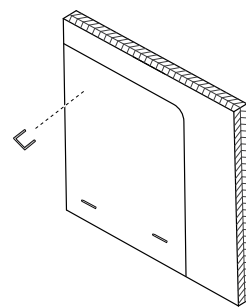
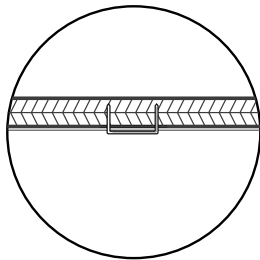
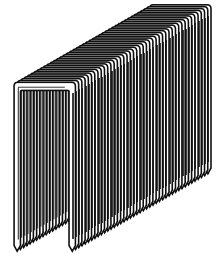
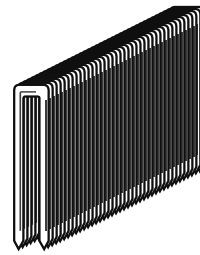
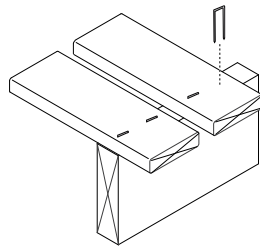
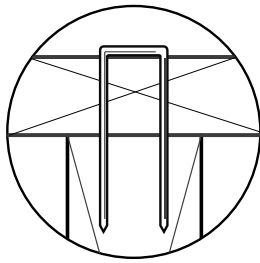

Chisel Point

Description Construction staples for quick fastening of construction materials.

Specifications

Size | Gauge: 23 to 18
Length: 1/2 in. to 2 1/2 in.
Crown Size: 3/16 in. to 1 in.
Point Type: Chiseled
Finish: Electrogalvanized,
 Mechanically Galvanized

Quality Assurance: Grabber® fasteners are manufactured in ISO 9001 and ISO 14001 certified and approved factories.

LEED Reporting: The post-consumer recycled steel content is 25%.

Compliance: The fasteners comply with ASTM F1667 performance requirements.

Applications

Narrow Crown

- Molding
- Cabinets
- Trim
- Paneling
- Drawer Construction
- Upholstery
- Gift Boxes

Medium Crown

- Furniture
- Pallet/Crate Construction
- Sheathing
- Subflooring
- Roof Material

Wide Crown

- Roof Material
- Packaging

Staples

Upholstery, Plastic, Molding, and Wood-to-Wood



Installation

- Ensure that the crown size and the gauge match the specifications for the stapler being used.
- Always load the stapler with the chiseled point facing away from the handle of the stapler.
- It is best to drive the staple at a 90° angle to the work surface.
- When choosing the staple length, multiply the length of the material being fastened by three, or the closest shorter leg length.
- For thin material such as fabric or cloth, add 3/16 in. for the staple length, or the closest shorter leg length.
- For hard materials, it is recommended to double the thickness of the material, or the closest shorter leg length.

Features

- Narrow crown staples for low visibility finishing on cabinetry and furniture building.
- Medium crown staples for a larger area, often used in home construction.
- Wide crown staples are used when visibility is not an issue, and they are mainly used in construction and packaging.
- Electrogalvanized staples have a thin layer of zinc for added protection against corrosion.
- The chiseled point penetrates the wood quickly.



Product Dimensions

| Gauge | Wire Diameter |
|-------|---------------|
| 23 | 0.031 in. |
| 22 | 0.022 in. |
| 20 | 0.019 in. |
| 18 | 0.044 in. |
| 16 | 0.055 in. |

Ordering Information and Product Options

| Item No. | Leg | Coating | Amount | Weight | Special Features |
|----------------------|----------|-------------------|--------|---------|------------------|
| 23 Gauge | | | | | |
| 3/8 in. Crown | | | | | |
| A1914 | 1/4 in. | Electrogalvanized | 5,000 | 1 lb. | |
| 22 Gauge | | | | | |
| 3/8 in. Crown | | | | | |
| 716 | 1/4 in. | Electrogalvanized | 10,000 | 1 lb. | |
| 718 | 5/16 in. | Electrogalvanized | 10,000 | 1.5 lb. | |
| 710 | 3/8 in. | Electrogalvanized | 10,000 | 2 lb. | |
| 7112 | 1/2 in. | Electrogalvanized | 10,000 | 2 lb. | |
| 7114 | 9/16 in. | Electrogalvanized | 10,000 | 2 lb. | |

Staples

Upholstery, Plastic, Molding, and Wood-to-Wood

GRABBER
CONSTRUCTION PRODUCTS

Ordering Information and Product Options (continued)

| Item No. | Leg | Coating | Amount | Weight | Special Features |
|-----------------------|-----------|-------------------|--------|---------|------------------|
| 20 Gauge | | | | | |
| 3/8 in. Crown | | | | | |
| A1138 | 3/8 in. | Electrogalvanized | 5,000 | 1.5 lb. | |
| A1112 | 1/2 in. | Electrogalvanized | 5,000 | 2 lb. | |
| 18 Gauge | | | | | |
| 3/16 in. Crown | | | | | |
| GSN1812 | 1/2 in. | Electrogalvanized | 5,000 | 3 lb. | |
| GSN1858 | 5/8 in. | Electrogalvanized | 5,000 | 3.5 lb. | |
| GSN1834 | 3/4 in. | Electrogalvanized | 5,000 | 4 lb. | |
| GSN1878 | 7/8 in. | Electrogalvanized | 5,000 | 4.5 lb. | |
| GSN181 | 1 in. | Electrogalvanized | 5,000 | 5 lb. | |
| GSN18118 | 1 1/8 in. | Electrogalvanized | 5,000 | 6 lb. | |
| GSN18114 | 1 1/4 in. | Electrogalvanized | 5,000 | 6.5 lb. | |
| GSN18112 | 1 1/2 in. | Electrogalvanized | 5,000 | 7.5 lb. | |
| 7/32 in. Crown | | | | | |
| SX503512 | 1/2 in. | Electrogalvanized | 5,000 | 3 lb. | |
| SX503558 | 5/8 in. | Electrogalvanized | 5,000 | 3 lb. | |
| SX503534 | 3/4 in. | Electrogalvanized | 5,000 | 4 lb. | |
| SX503578 | 7/8 in. | Electrogalvanized | 5,000 | 4 lb. | |
| SX50351 | 1 in. | Electrogalvanized | 5,000 | 5 lb. | |
| SX5035118 | 1 1/8 in. | Electrogalvanized | 5,000 | 5 lb. | |
| SX5035114 | 1 1/4 in. | Electrogalvanized | 5,000 | 6 lb. | |
| SX5035112 | 1 1/2 in. | Electrogalvanized | 5,000 | 7 lb. | |
| 1/4 in. Crown | | | | | |
| L08 | 1/2 in. | Electrogalvanized | 5,000 | 3 lb. | |
| L10 | 5/8 in. | Electrogalvanized | 5,000 | 3 lb. | |
| L11 | 3/4 in. | Electrogalvanized | 5,000 | 4 lb. | |
| L12 | 7/8 in. | Electrogalvanized | 5,000 | 4.5 lb. | |
| L13 | 1 in. | Electrogalvanized | 5,000 | 5 lb. | |
| L14 | 1 1/8 in. | Electrogalvanized | 5,000 | 6 lb. | |
| L15 | 1 1/4 in. | Electrogalvanized | 5,000 | 6 lb. | |
| L17 | 1 1/2 in. | Electrogalvanized | 5,000 | 7 lb. | |
| 16 Gauge | | | | | |
| 7/16 in. Crown | | | | | |
| N11 | 3/4 in. | Electrogalvanized | 10,000 | 15 lb. | |
| N13 | 1 in. | Electrogalvanized | 10,000 | 18 lb. | |
| N14 | 1 1/8 in. | Electrogalvanized | 10,000 | 20 lb. | |
| N15 | 1 1/4 in. | Electrogalvanized | 10,000 | 21 lb. | |
| N17 | 1 1/2 in. | Electrogalvanized | 10,000 | 26 lb. | |
| N19 | 1 3/4 in. | Electrogalvanized | 10,000 | 30 lb. | |
| N21 | 2 in. | Electrogalvanized | 10,000 | 33 lb. | |

Staples

Upholstery, Plastic, Molding, and Wood-to-Wood



Ordering Information and Product Options (continued)

| Item No. | Leg | Coating | Amount | Weight | Special Features |
|-----------------------------|-----------|-------------------------|--------|--------|------------------|
| 16 Gauge (continued) | | | | | |
| 1/2 in. Crown | | | | | |
| 16S420G | 3/4 in. | Mechanically Galvanized | 10,000 | 16 lb. | |
| 16S422G | 7/8 in. | Mechanically Galvanized | 10,000 | 17 lb. | |
| 16S425G | 1 in. | Mechanically Galvanized | 10,000 | 19 lb. | |
| 16S428G | 1 1/8 in. | Mechanically Galvanized | 10,000 | 20 lb. | |
| 16S432G | 1 1/4 in. | Mechanically Galvanized | 10,000 | 23 lb. | |
| 16S434G | 1 3/8 in. | Mechanically Galvanized | 10,000 | 24 lb. | |
| 16S438G | 1 1/2 in. | Mechanically Galvanized | 10,000 | 26 lb. | |
| 16S444G | 1 3/4 in. | Mechanically Galvanized | 10,000 | 30 lb. | |
| 16S450G | 2 in. | Mechanically Galvanized | 10,000 | 33 lb. | |
| 15/16 in. Crown | | | | | |
| GSW1634 | 3/4 in. | Electrogalvanized | 10,000 | 18 lb. | |
| GSW1678 | 7/8 in. | Electrogalvanized | 10,000 | 20 lb. | |
| GSW161 | 1 in. | Electrogalvanized | 10,000 | 21 lb. | |
| GSW16114 | 1 1/4 in. | Electrogalvanized | 10,000 | 25 lb. | |
| GSW16112 | 1 1/2 in. | Electrogalvanized | 10,000 | 30 lb. | |
| GSW16134 | 1 3/4 in. | Electrogalvanized | 10,000 | 33 lb. | |
| GSW162 | 2 in. | Electrogalvanized | 10,000 | 36 lb. | |
| 1 in. Crown | | | | | |
| BCS1096 | 5/8 in. | Electrogalvanized | 10,000 | 17 lb. | |
| P10 | 5/8 in. | Electrogalvanized | 10,000 | 18 lb. | |
| BCS1097 | 3/4 in. | Electrogalvanized | 10,000 | 19 lb. | |
| P11 | 3/4 in. | Electrogalvanized | 10,000 | 19 lb. | |
| BCS1098 | 7/8 in. | Electrogalvanized | 10,000 | 21 lb. | |
| P12 | 7/8 in. | Electrogalvanized | 10,000 | 21 lb. | |
| BCS1099 | 1 in. | Electrogalvanized | 10,000 | 22 lb. | |
| P13 | 1 in. | Electrogalvanized | 10,000 | 23 lb. | |
| BCS1101 | 1 1/4 in. | Electrogalvanized | 10,000 | 26 lb. | |
| P15 | 1 1/4 in. | Electrogalvanized | 10,000 | 27 lb. | |
| BCS1102 | 1 1/2 in. | Electrogalvanized | 10,000 | 30 lb. | |
| P17 | 1 1/2 in. | Electrogalvanized | 5,000 | 15 lb. | |
| BCS1116 | 1 3/4 in. | Electrogalvanized | 5,000 | 17 lb. | |
| BCS1117 | 2 in. | Electrogalvanized | 5,000 | 19 lb. | |
| P21 | 2 in. | Electrogalvanized | 5,000 | 18 lb. | |

Note: Product availability is subject to change without prior notice, and the availability of products may differ from what is printed in literature and displayed on our website.

Staples
PS1072 USA-ENG/Rev. 02-25

GRABBER CONSTRUCTION PRODUCTS, INC.
5255 W 11000 N., STE 100
HIGHLAND, UT 84003

(800) 477-8876 | GrabberPro.com

SAFETY FIRST: Wear appropriate personal protective equipment. Read applicable SDS and literature before handling and installation.

TECHNICAL INFORMATION: Technical information contained herein is furnished without charge or obligation and is given and accepted at the recipient's sole risk. Because conditions of use may vary and are beyond our control, Grabber Construction Products makes no representation about, and is not responsible or liable for, the accuracy or reliability of data associated with uses of any product described herein. Grabber Construction Products reserves the right to modify this document without prior notice.

© 2025 Grabber Construction Products, Inc. | All rights reserved | Printed in U.S.A.
The trademarks Grabber, and Stylized Gon Grabber Fasteners, are trademarks of Grabber Construction Products, Inc.

