

# Scavenger® Head Drywall Screw

Interior Wood

**GRABBER®**  
CONSTRUCTION PRODUCTS

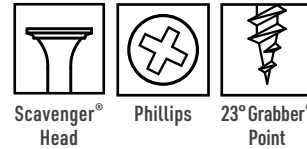
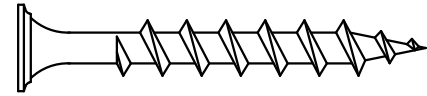
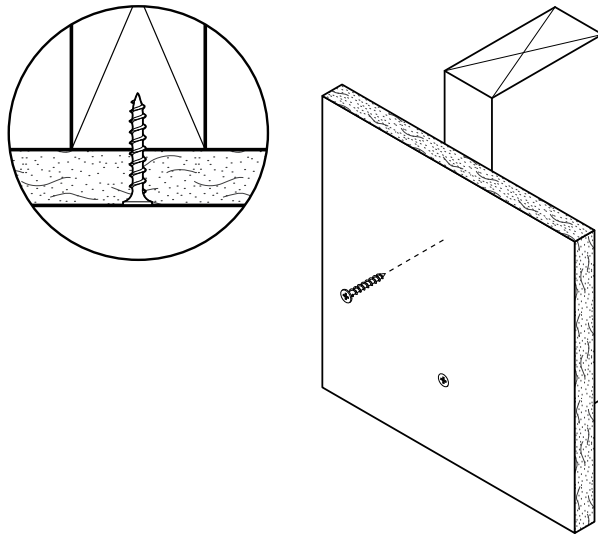

**Description**      Attaches gypsum board to wood.

## Specifications

**Size | Gauge:** #6 to #7  
**Length:** 1 in. to 2 in.  
**Head Type:** Scavenger®  
**Recess Type:** #2 Phillips  
**Thread Type:** Single Lead, Coarse  
**Finish:** Phosphate

**Quality Assurance:** Grabber® fasteners are manufactured in ISO 9001 and ISO 14001 certified and approved factories.

**LEED Reporting:** The post-consumer recycled steel content is 25%.

**Compliance:** The fasteners comply with ASTM C1002 performance requirements.

## Applications

- 3/8 in., 1/2 in., and 5/8 in. single-layer gypsum board to wood studs
- 1/2 in. and 5/8 in. double-layer gypsum board to wood studs
- Sheathing and insulation board to wood studs

## Installation

- Use a standard screw gun with a depth-sensitive nose piece. Suggested screw gun specification for optimal performance: sizes #6 and #7, up to 4,000 RPM.
- For gypsum board, the Scavenger® head is fully seated when the screw is below the surface of the wallboard, in accordance with ASTM C1002.
- The fastener should penetrate into the wood at least 5/8 in., in accordance with AWC-NDS for wood construction.
- Overdriving may result in failure of the fastener or failure of the gypsum board.

## Features

- Superior holding power and ease of penetration.
- A coarse thread screw for general interior applications into wood.
- Extra-sharp, single-lead 23° Grabber® point designed to penetrate quickly and easily.
- The unique Scavenger® double bugle head design reduces paper burrs.

# Scavenger® Head Drywall Screw

## Interior Wood

# GRABBER®

CONSTRUCTION PRODUCTS

### Standard Corrosion Test Results

Finish	Test	Standard/Protocol	Results
Phosphate	Salt Spray	ASTM B117	24 hrs., no red rust

Note: Salt Spray Testing (SST) results are not intended to predict corrosion in real-world environments. The ASTM B117 standard for SST is recognized industry-wide as an effective tool for comparing different metals and different metal coatings in a tightly controlled, highly corrosive environment for specific periods of time. For more information about corrosion resistance, refer to Grabber's Coatings and Corrosion Resistance Classifications in the Technical Data section of Grabber Fastener Solutions, PG1000. Consult with a corrosion specialist or the architect or engineer of record for detailed guidance and recommendations specific to your project.

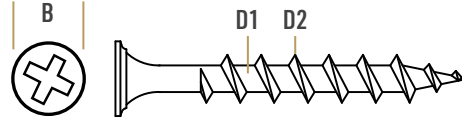

### Product Dimensions

Size	B Head Dia.	Recess	D1 Minor Dia.	D2 Major Dia.	TPI <sup>1</sup>
#6	0.325 in.	#2 Phillips	0.089 in.	0.138 in.	8
#7	0.325 in.	#2 Phillips	0.100 in.	0.151 in.	8

<sup>1</sup>TPI stands for Threads Per Inch. This is a count of the number of threads per inch measured along the length of a fastener.

### Ordering Information and Product Options

Item No.	Size	Recess	Head Diameter	TPI <sup>1</sup>	Quantity	Weight	Special Features
<b>Phosphate</b>							
108	6 x 1 in.	#2 Phillips	0.325 in.	8	10,000	29 lb.	
208	6 x 1 1/8 in.	#2 Phillips	0.325 in.	8	10,000	35 lb.	
308	6 x 1 1/4 in.	#2 Phillips	0.325 in.	8	8,000	29 lb.	
408	6 x 1 5/8 in.	#2 Phillips	0.325 in.	8	5,000	24 lb.	
508	7 x 2 in.	#2 Phillips	0.325 in.	8	3,500	23 lb.	
C208	6 x 1 1/8 in.	#2 Phillips	0.325 in.	8	1,000	5 lb.	Collated
C308	6 x 1 1/4 in.	#2 Phillips	0.325 in.	8	1,000	5 lb.	
CB308	6 x 1 1/4 in.	#2 Phillips	0.325 in.	8	1,000	5 lb.	Collated, Bucket
C408	6 x 1 5/8 in.	#2 Phillips	0.325 in.	8	1,000	5 lb.	Collated
CB408	6 x 1 5/8 in.	#2 Phillips	0.325 in.	8	1,000	5 lb.	Collated, Bucket

<sup>1</sup>TPI stands for Threads Per Inch. This is a count of the number of threads per inch measured along the length of a fastener.

Note: Product availability is subject to change without prior notice and the availability of products may differ from what is printed in literature and displayed on our website. The items listed are bulk size. Most are also available in smaller packages such as 5 lb. and 1 lb. Contact your local Grabber Branch or GrabberPro for more information.

Scavenger® Head Drywall Screw  
PS1028 USA-ENG/Rev. 02-25

GRABBER CONSTRUCTION PRODUCTS, INC.  
5255 W 11000 N., STE 100  
HIGHLAND, UT 84003

(800) 477-8876 | GrabberPro.com

**SAFETY FIRST:** Wear appropriate personal protective equipment. Read applicable SDS and literature before handling and installation.

**TECHNICAL INFORMATION:** Technical information contained herein is furnished without charge or obligation and is given and accepted at the recipient's sole risk. Because conditions of use may vary and are beyond our control, Grabber Construction Products makes no representation about, and is not responsible or liable for, the accuracy or reliability of data associated with uses of any product described herein. Grabber Construction Products reserves the right to modify this document without prior notice.

© 2025 Grabber Construction Products, Inc. | All rights reserved | Printed in U.S.A.  
The trademarks Grabber, Scavenger, and Stylized G on Grabber Fasteners, are trademarks of Grabber Construction Products, Inc.

